

# DIAGNOS **DENGUE CARD**

Rapid Visual test for the Differential Detection of IgM & IgG Antibodies  
to Dengue Virus in Human Serum/ Plasma

## **Salient Features:**

- ✓ Rapid, visual and qualitative immunoassay
- ✓ Differential detection of **IgM** & **IgG** antibodies
- ✓ Detects all 4 serotypes (Den-1, Den-2, Den-3 & Den-4) of Dengue
- ✓ Easy to read colour result bands
- ✓ See-through device for easy interpretation of results
- ✓ Built-in Quality Control Line
- ✓ Results within **20 minutes**
- ✓ Shelf life **24 months** at **2-30°C**
- ✓ Convenient Pack size : 10 Tests

## **Sensitivity & Specificity**

**Sensitivity: 95%**

**Specificity: 97%**



## What is Clinical Significance of Dengue Antibody Tests?

Dengue virus infection causes a wide range of diseases from dengue fever to life threatening Dengue Haemorrhagic Fever, Dengue Shock Syndrome (DHF & DSS). The presence of antibodies to dengue virus i.e IgM & IgG could be detected in patient sera. So the Primary and Secondary infection can be classified by determining the ratio of IgM antibodies to IgG antibodies. They showed that acute phase sera from patient with primary dengue infection had higher IgM/IgG ratio where as sera from patients with secondary infection had lower IgM/IgG ratio. Hence detection of both IgM & IgG is significant for the diagnosis of Dengue.

### Simple to Perform

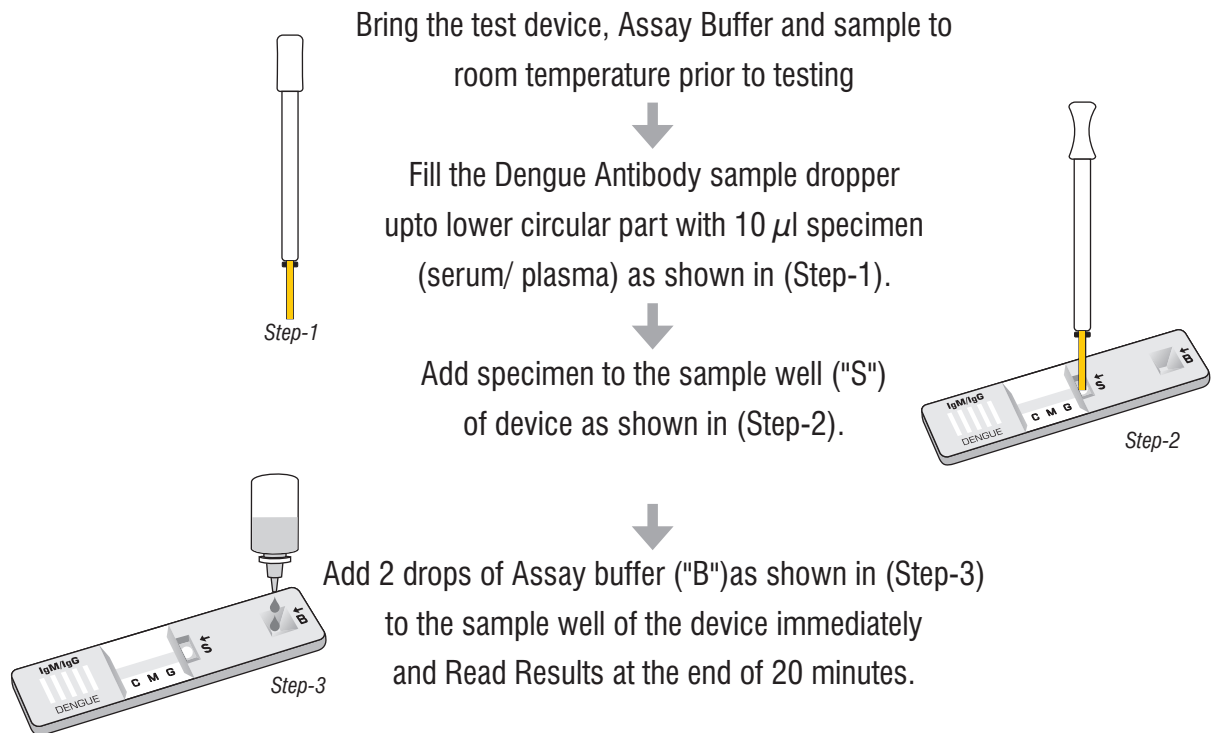

### Result Interpretation

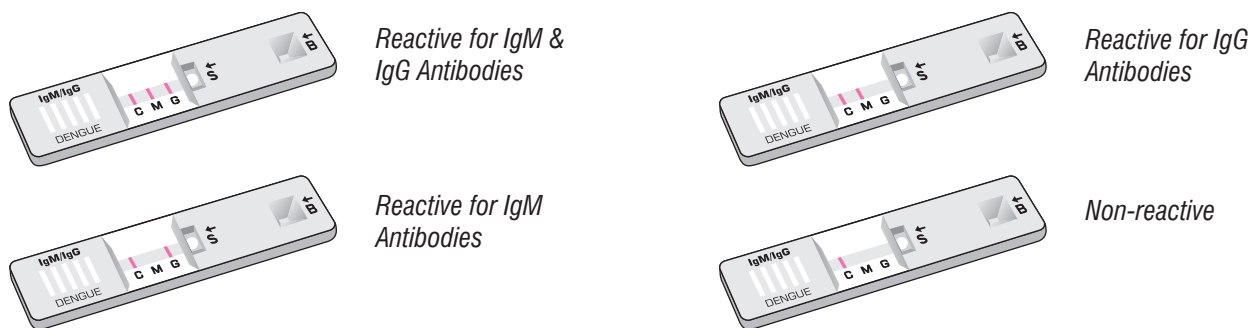

Also Connect with us on:



For further enquiries, Please contact:

**J. Mitra & Co. Pvt. Ltd.**

A 180-181, Okhla Indl. Area, Phase-1, New Delhi - 110 020, INDIA

Tel: +91-11-47130300, 47130500

E-mail: [jmitra@jmitra.co.in](mailto:jmitra@jmitra.co.in) Website: [www.jmitra.co.in](http://www.jmitra.co.in)